

DISEASES DON'T RESPECT BORDERS

WHAT ARE THE RULES?

www.one-health.eu



FOOD IMPORTS

Personal imports of meat and dairy products brought into the EU present a real threat to animal health, as they can contain various pathogens that cause animal diseases, such as foot and mouth disease.

So by bringing meat and dairy products into the EU, you risk importing an animal disease.

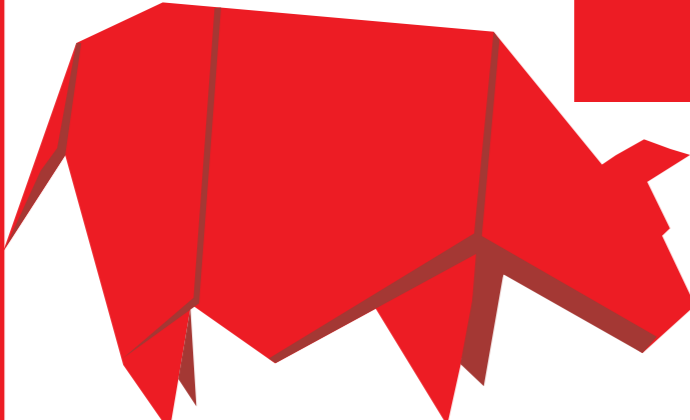

Can I bring meat or dairy products into the EU?

In general, you cannot bring with you any meat or dairy products, unless they are in small quantities for personal consumption from Andorra, Croatia, the Faeroe Islands, Greenland, Iceland, Liechtenstein, Norway, San Marino or Switzerland.

Such products are also not allowed to be sent in packages to individuals, with limited exceptions.

What about other products of animal origin?

If you want to bring small quantities of products of animal origin other than meat and dairy products - honey, eggs, fish, etc. - into the EU for personal consumption, please check the rules with the competent authority.

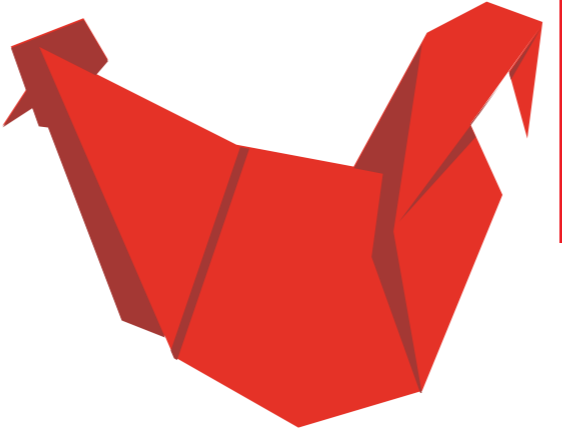

What about infant milk or food?

You can bring in limited quantities of powdered infant milk and food, and foods required for medical reasons provided that:

- they do not require refrigeration before opening
- they are packaged proprietary brand products for direct sale to the final consumer, and
- the packaging is unbroken unless they are currently being used.

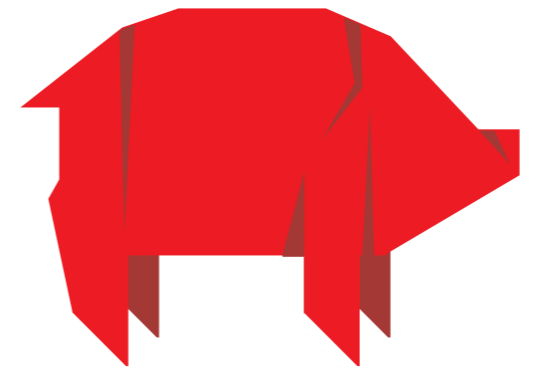

What happens if I break the rules?

- The products will be seized and destroyed on arrival into the EU.
- If you do not declare such items, you may be fined or face criminal prosecution.

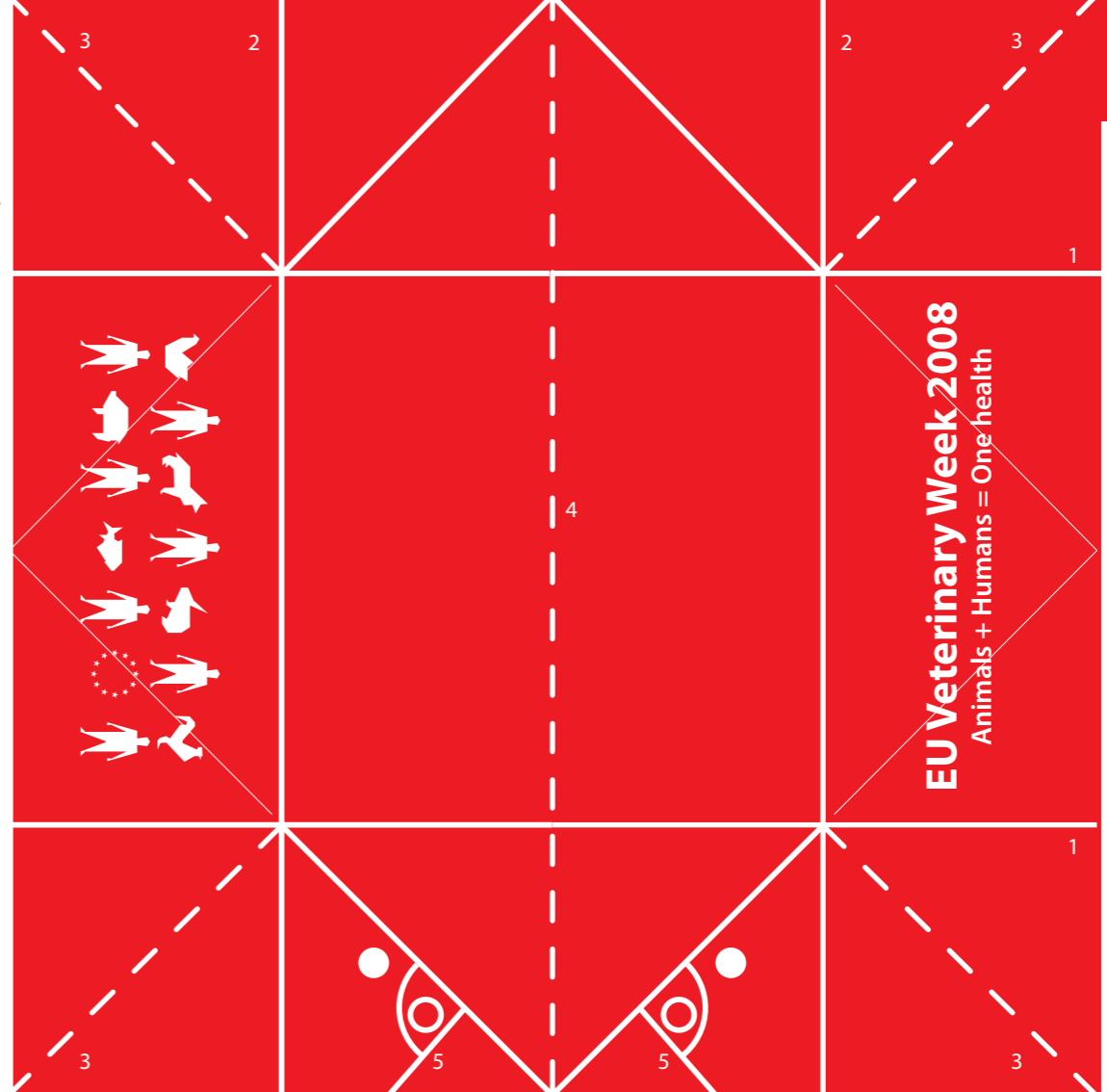

EU Veterinary Week 2008
Animals + Humans = One health

>> How to make your own pig

Step 5:
Unfold the corners and flatten them out by overlaying the two Lines 3

Step 6:
Make the legs by folding the triangles so that Line 3 lies over Line 1. Press down the folds

Step 7:
Make the snout by refolding the end of the pig's nose towards the inside along Lines 5

Step 8:
Fold the curly tail and smooth out the folds because it is that which prevents the pig from opening

How to make your own pig

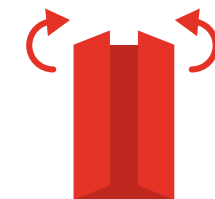

Step 1:

Fold the sheet along Lines 1

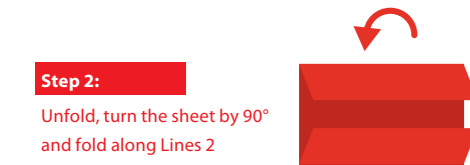

Step 2:

Unfold, turn the sheet by 90° and fold along Lines 2

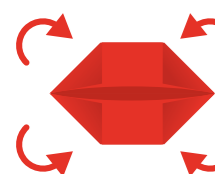

Step 3:

Fold the four corners along Lines 3



Step 4:

Fold the sheet into two along Line 4

To continue, please turn over >>>

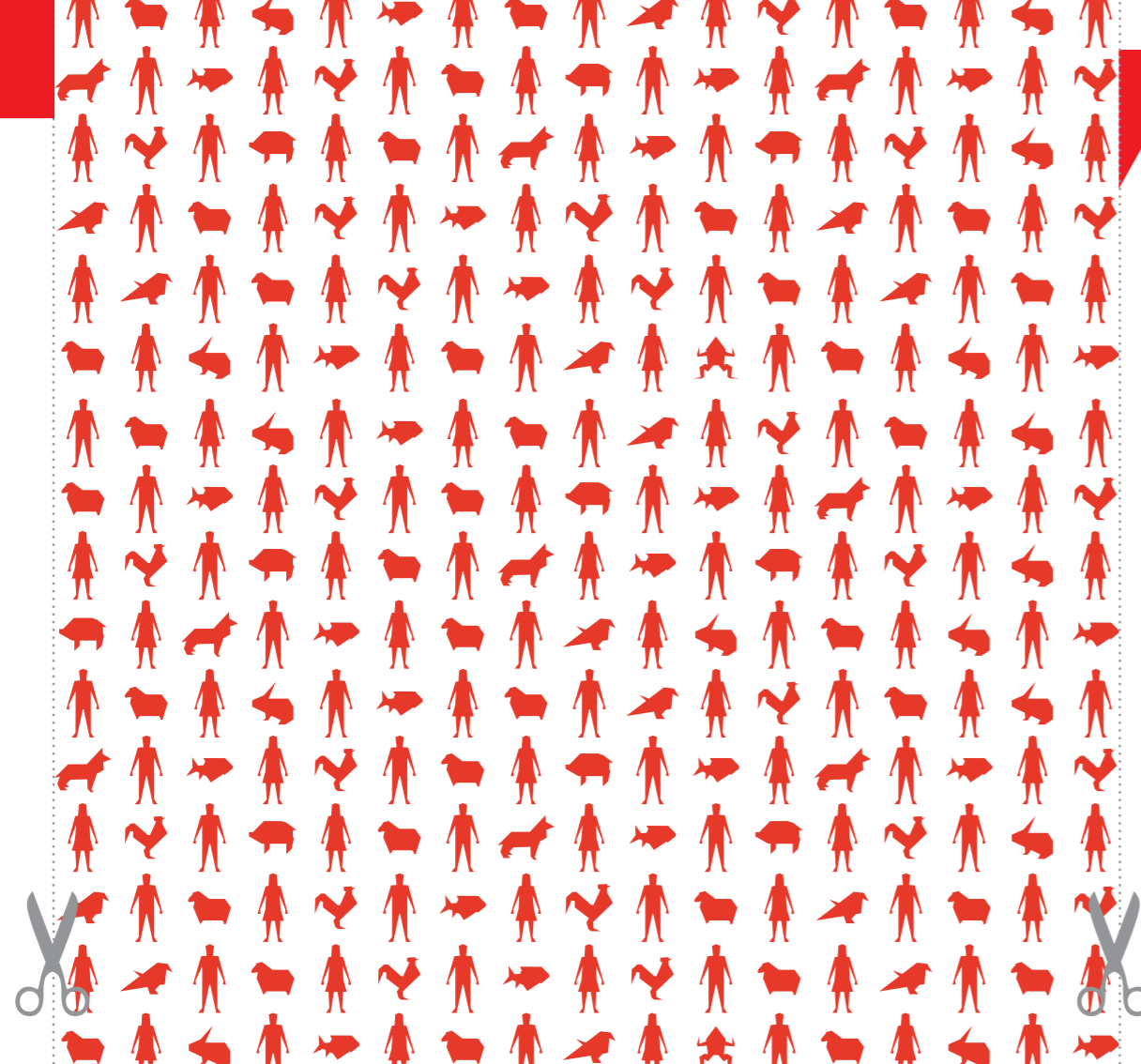

PET IMPORTS

In many non-EU countries, diseases that have been eradicated in most EU Member States still exist. A clear example is rabies, which if you catch it is almost always fatal.

So if you bring an animal into the EU from such a country – without following the correct procedures – you risk importing such diseases and putting yourself, friends and family, and other people at risk.



The rules

The following rules are for importing cats, dogs and ferrets.

For information on other animals, please go to: http://ec.europa.eu/food/animal/liveanimals/other/index_en.htm

The rules for importing pets vary depending on where you are coming from and travelling to.

So contact your vet or national authority to find out what rules apply to you and your pet.

I am travelling to:

a Member State other than Ireland, Malta, Sweden and the United Kingdom (UK)...
... from a country meeting the standard requirements

Your pet will need:

- valid Veterinary Certification from your veterinarian
- identification – an electronic microchip (transponder) or tattoo (only valid until 2011)
- valid anti-rabies vaccination
- tapeworm treatment (Finland only).

...from a country not meeting the standard requirements

In addition, a veterinarian authorised by the national competent authority must take a blood sample from your pet at least 30 days after vaccination and three months before travel. An approved lab then tests this sample to check the level of immunity.

I am travelling to:

Ireland, Malta, Sweden or the UK

These countries impose specific conditions on importing your pet. Depending on where you are travelling from, a veterinarian authorised by the national competent authority may need to take a blood sample from your pet or it may be quarantined.

For more information on precise national conditions, go to:
Ireland: www.agriculture.gov.ie
Malta: www.veterinary.gov.mt
Sweden: www.sjv.se
UK: www.defra.gov.uk

What happens if I break the rules?

- Your pet may be sent back.
- It may be isolated and quarantined under official control for the time needed for it to meet the health requirements.
- As a last resort, your pet may be put down.



www.one-health.eu